



09 25 13

Soffit System

Direct Applied Finish System

The Master Wall Soffit System application greatly improves the looks of any eave, overhang, canopy or large soffit. The textured surface and installed system is impact resistant and durable, yet with an economical cost compared to other soffit alternatives.

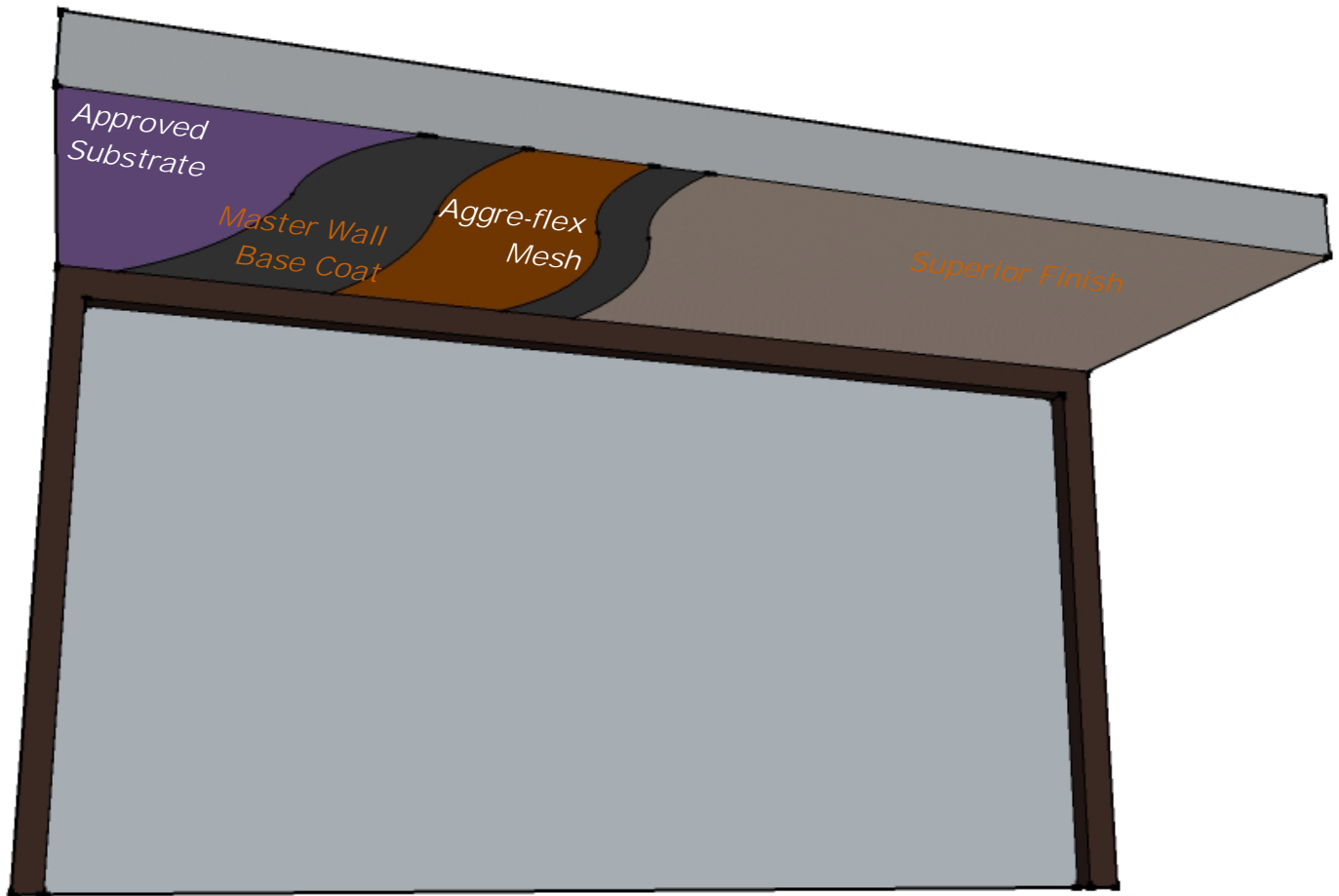

Features & Benefits

System Uses



- Easy Installation
- Great Aesthetics
- Economical



©2011 Master Wall Inc.

P. O. Box 397
 Fortson, GA 31808
 800-755-0825
 Technical 800-760-2861
 masterwall.com

050111

Soffit System Short Form Specification

09 25 13



1.0 General

This is a short form specification. Refer to Soffit System specifications and details for additional information.

1.1 System Description

The Master Wall Soffit System is a Direct-applied Exterior Finish System consisting of a reinforced base coat and a textured finish.

1.2 Design Requirements:

- A. Reference Master Wall suggested details and architectural drawings for specific detail requirements.
- B. Maximum deflection of substrates shall not exceed L/360.
- C. Typical acceptable substrates include Exterior Gypsum Soffit Board, Dens Glass Gold[®] (ASTM C-1177), FiberRock[®], Durock[®], PermaBase[®], Hardie Tex[®] or Eterspan[®]. Contact Master Wall for other approved substrates.
- D. Expansion joints are required at building expansion joints, panel joints and other areas where significant movement occurs.
- E. Control joints are required to be located by the designer. Reference Master Wall specifications for specific recommendations.
- F. Detail and install trim accessories according to the approved trim manufacturer's requirements (Plastic Components, Vinyl Corp. or approved equal).

See full specifications and
details at masterwall.com

1.3 Quality Assurance

- A. The system shall be tested for: Accelerated weathering, mildew resistance, salt spray resistance and structural performance.
- B. The system shall have been tested for fire performance in accordance with ASTM E-84.

1.4 Job Conditions

- A. Store all materials protected from weather and direct sunlight at temperatures above 40°F (5°C).
- B. The ambient and wall temperature shall be a minimum of 40°F (5°C) and shall remain so for at least 24 hours after installation.

2.0 Products

All components of the Soffit System shall be manufactured by Master Wall and supplied by an authorized distributor.

A. Master Wall Base Coats:

1. *Foam & Mesh Adhesive (F&M)*: A 100% pure acrylic-based adhesive that is field mixed with Portland cement.
2. *F&M Plus*: A high-build 100% pure acrylic-based fiber reinforced adhesive that is field mixed with Portland cement.
3. *Master Wall Bagged Base (MBB)*: A ready to use dry base that is field mixed with water.

B. *Aggre-flex Mesh*: Standard or Detail Mesh.

C. Superior Finish: 100% pure acrylic formulation with integral color and texture. Perfect, Spray, Desert Sand, R-Coarse and Refinish textures.

D. Master Wall Coatings:

1. *Primecoat*: A water-based primer.
2. *Roller-flex*: A water-based architectural finish coating.

3.0 Installation

- A. Inspect the substrate to ensure that it is free of all foreign materials that would affect the adhesion of the Master Wall System.
- B. Apply the system in strict accordance with Master Wall specifications, product data sheets, architectural drawings and architectural specifications.

More Information



Soffit System