



Rollershield-RS

Systems

Rollershield Drainage EIFS
Rollershield LAB
Cemplaster Fiberstucco
Common Cladding Systems

VOC: <1% by Weight

VOC: 10 g/l

**Manufacture Locations:
30058 • 77474 • 84651**

Packaging: 5 gallon (19L) pail

Pail Weight: 60 lbs (27 kg)

Shelf Life: 2 years

Coverage (estimated per pail)

Roller: 450-500 sf (42-46 sm)

Spray: 300-350 sf (28-32.5 sm)

Trowel: 200-250 sf (18-23 sm)

Dry to Touch: 1 hour @ room temperature

Recoat Time: 2 hours @ room temperature

Drying Time: 12 hours @ room temperature

Application Range: 40°-110°F (5°-43°C)

Exposure: 30 days maximum for EIFS*, 6 months maximum for other claddings.

*surface must be clean and dry prior to application of EIFS

Rollershield-RS is a high quality 100% acrylic flexible air and water barrier. Rollershield-RS is intended for roller or spray application but also can be troweled or brushed into place. Rollershield-RS forms a continuous air and water barrier that protects approved substrates from incidental water damage.



- **100% Coverage**
- **Doesn't rattle in the wind**
- **Vapor permeable with low air infiltration rate**
- **Used as water barrier and flashing**



Air/Water Barriers

Product Test Standards

ASTM C297/E2134, ASTM D1970 (@ 22 mils dft), ASTM D2247, ASTM E72, ASTM E84, ASTM E96 (30 perms @ 10 mils), ASTM E331, ASTM E1233, ASTM E2178 (0.0002 cfm/ft²), ASTM E2357 (0.003 L/sm² @ 75 Pa, 0.02 L/sm² @ 300 Pa), ASTM E2485, AATCC 127, ICC ES (AC 212), NFPA 285



M Master Wall Inc.®
Building a Culture of Excellence

masterwall.com

PO Box 397 • Fortson • GA • 31808 • 800-755-0825 • Tech: 800-760-2861



Rollershield-RS

Temp: 40°-110°F (5°-43°C) • Dry to Touch: 1 hour • Dry Time: 12 hrs
at room temperature, working and drying time will vary with temperature and humidity

Application Procedure

Job Conditions - Air and substrate temperature for application of Rollershield-RS must be 40°F (5°C) or higher and must remain 40°F (5°C) or higher for a minimum of 24 hours. Provide temporary protection to protect the wall system from damage until permanent flashings, caps and sealants are installed. Store materials within prescribed temperature limits and out of direct sunlight. Working and drying times are based upon normal room temperature conditions and will vary with temperature and humidity.

Preparation - The substrate must be approved by Master Wall Inc., clean, dry, structurally sound and free of efflorescence, oil, grease, form release agents and curing compounds or anything that would affect bond. Painted surfaces are not acceptable and must be removed. Substrates must be flat and free of fins or planar irregularities greater than 1/4" in 10'-0" (6.35 mm in 3.05m).

Concrete - Must have cured a minimum of 28 days prior to the application of Rollershield-RS. If form release agents or curing compounds exist on the surface, they must be removed with a solution of muriatic acid or similar product (with appropriate precautions). Remove any residual acid by flushing with water.

Brick/Masonry - If joints are not struck flush, multiple coats may be required. Contact Master Wall for more information.

Sheathing Applications - Sheathing gaps must be less than 1/4" (6.4 mm). For gaps larger than 1/4" (6.4 mm) WeatherStop Tape or Rollershield Flashing Tape may be used. Gap wood-based sheathing per manufacturers recommendations, typically 1/8" (3.2 mm) minimum.

Mixing - Thoroughly stir Rollershield-RS into a homogenous consistency. Do not add water, over mix, or add accelerators or retarders to Rollershield-RS.

Application - Rollershield-RS is applied by first treating the joints and fastener locations where sheathing is used, then coating the entire surface using brush, roller, trowel or airless spray equipment techniques. When using a foam roller, a maximum 3/4" (19 mm) nap is recommended. Apply Rollershield-RS in an even, continuous coat, maintaining a wet edge of approximately 15 mils thickness. Oriented Strand Board and other porous substrates require two (2) coats of Rollershield-RS. For moisture protection, Rollershield-RS must be applied as a continuous barrier of 10 mils dry thickness with no breaks or skips, although some areas will appear lighter than others due to the application process. The Rollershield-RS application need not look like a painted surface.

Approved Substrates

Exterior gypsum sheathing (ASTM C1396)
Dens Glass Gold®
GlasRoc®
FiberBond®
Gold Bond e2xp®
Durock®
PermaBase®
ProTEC®
Util-A-Crete®
Concrete
Brick
Masonry
Exterior Plywood
Oriented Strand Board
Others approved in writing

Joint Treatment—Apply a thin layer of Rollershield-RS to the joints and embed Rollershield Flashing Tape into the wet mixture and trowel smooth. Alternatively place and center Rollershield-RS Mesh over all joints, corners and gaps in the substrate. Immediately embed Rollershield-RS into the reinforcing mesh and spot fasteners using a paint brush or trowel and allow to dry.

Rollershield-RS may be flashed into window, door and other openings using the same techniques for sheathing applications. Any remaining gaps should be filled with Master Wall Rollershield-TG (Trowel Grade) or SuperiorFlash.

Wall Treatment—Apply Rollershield-RS to the wall surface using the foam roller, trowel or by spray applying and backrolling to a uniform thickness of 15 mils wet, 10 mils dry with no pinholes or voids.

Clean Up-Tools and equipment can be cleaned with soapy water when Rollershield-RS is wet.

Limitations - Not for use as an exterior finish, note exposure limitations on front page.

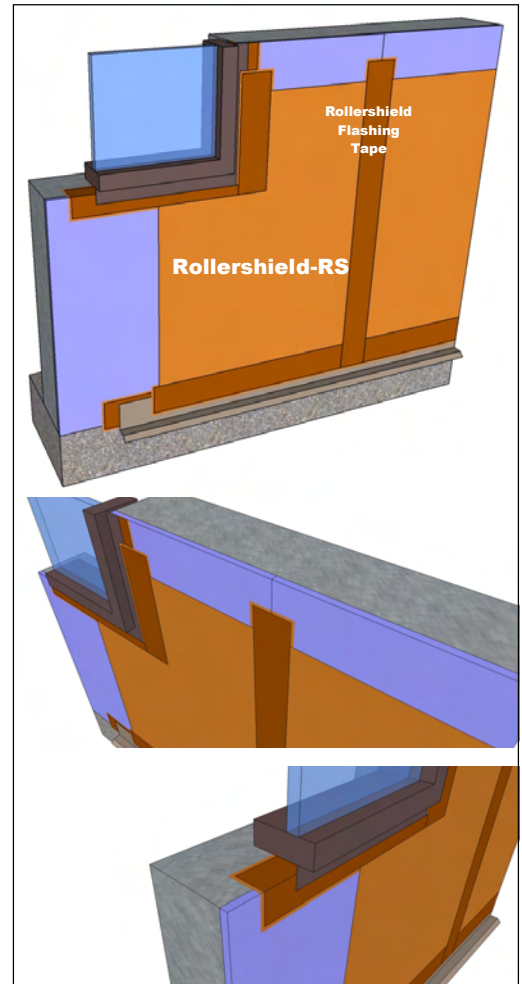

Spray Application

Rollershield-RS is compatible with GRACO and Titan airless spray equipment with the following specifications:

- Minimum 1 gallon per minute output.
- Minimum hose width of 3/8 inch.
- Minimum tip size of 0.027–0.031.

Minimum pressure requirement to spray of 2,000 psi at the gun with an airless sprayer rated no lower than 3,300 psi. Remove all filters in sprayer and gun before application.

Hopper Gun: 3/16"-1/4" (6-6.5 mm) orifice, 23-25 psi.

Information contained in this product data sheet conforms to the standard detail recommendations and specifications for the installation of Master Wall Inc.® products and is presented in good faith. Master Wall Inc.® assumes no liability, expressed or implied as to the architecture, engineering, or workmanship of any project. This information may be concurrent with, or superseded by other applicable documents, such as specifications and details. Contact Master Wall Inc.® for the most current product information. ©2017 Master Wall Inc.®

 **Master Wall Inc.®**
Building a Culture of Excellence
masterwall.com

PO Box 397 • Fortson • GA • 31808 • 800-755-0825 • Tech: 800-760-2861