



Rollershield Flashing Tape

Systems

Rollershield Drainage EIFS
Rollershield LAB

Shipping Locations:

30058 • 77474 • 84651

Tape Size

Rollershield Flashing Tape is available in the following size rolls:

4"x180' (10.2cm x 54.9m)

6"x180' (15.2cm x 54.9m)

9"x180' (22.9cm x 54.9m)

Packaging

4": 18 rolls per case.

6" & 9": 12 rolls per case.

Coverage Estimate

(4x8 sheets)

Square Footage x 0.37 = linear feet of tape

Add linear footage around windows, doors and other openings.

(coverage is not guaranteed)

Rollershield Flashing Tape is a lightweight roll flashing material with superior strength and the ability to bridge most gaps or voids common in construction.

Embedded into wet Rollershield-RS, TG or VB, it is used at flashing transitions with Master Wall®

Rollershield air & water barrier applications. The tape easily embeds into wet Rollershield and dries to a highly reinforced yet flexible flashing.

- **Lightweight**
- **Embeds easily**
- **Thin, won't build up wall surface**

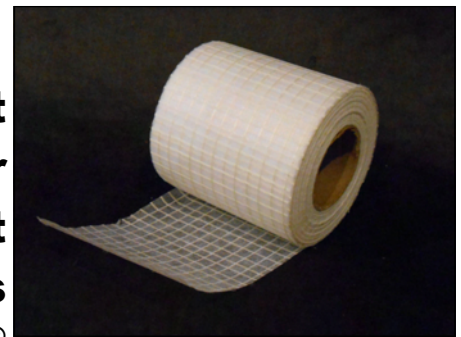

M Master Wall Inc.®
Building a Culture of Excellence

masterwall.com

PO Box 397 • Fortson • GA • 31808 • 800-755-0825 • Tech: 800-760-2861



Rollershield Flashing Tape

Application Procedure

General—The substrate must be clean, dry, structurally sound and free of efflorescence, oil, grease, form release agents and curing compounds. Test painted surfaces to verify bond.

Job Conditions - Air and substrate temperature for application of Rollershield Flashing Tape must be 40°F (5°C) or higher. Follow Rollershield-RS, TG or VB temperatures and condition requirements.

Temporary Protection – Protect from weather until the Rollershield-RS, TG or VB products have set up.

Surface Preparation - Surface temperature must be above 40°F (5°C). Surface must be cured, clean, dry, structurally sound and free of efflorescence, oil, grease, form release agents, and curing compounds.

Installation

General - Rollershield Flashing Tape is embedded into wet Rollershield-RS, TG or VB at flashing transitions (sheathing to framing, flashing, penetrations, etc.) and at sheathing board joints. Apply a generous layer of the product using a trowel, brush or roller and immediately embed the Rollershield Flashing Tape into the product and draw it tight and smooth working from the center to the edges.

Windows – The unique properties of the Rollershield air/water barrier system allows window flashing prior to the Rollershield wall application. Apply Rollershield at least 2" (51 mm) either side of the window opening. Use a "butterfly" at corners to complete the application making sure it covers all corner joints. For best results make sure the Rollershield covers the entire head, jamb and sill areas. The use of sill wedges or water stops is encouraged.

Sheathing Applications — Apply Rollershield at least 2" (51 mm) either side of the sheathing board joint. Immediately embed the Rollershield Flashing Tape into the wet Rollershield and smooth with a trowel, centering it over the joint. Lap Rollershield Mesh Tape 2" (51 mm) minimum

Rollershield field application can begin as soon as the Rollershield is dry to the touch.

Sheathing Application



Window Flashing Application

1. Start at the base of the window. Apply wet Rollershield using a trowel, brush or roller to the sill and face of the wall.
2. Center and embed Rollershield Flashing Tape into the wet Rollershield and extend up the wall 3" (75 mm) up the jambs and onto the face of the wall. Smooth using trowel, brush or roller.
3. Apply jamb flashing in a similar manner extending the flashing 3" min. onto the sill surface.
4. Apply head flashing in a similar manner.

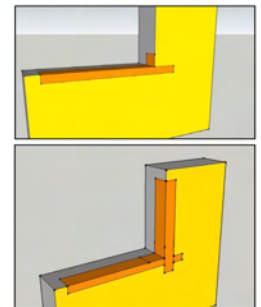

RSLAB-09 Basic Flashing – Method A

1. Start at the base of the window. Apply wet Rollershield using a trowel, brush or roller to the sill and face of the wall.
2. Center and embed Rollershield Flashing Tape into the wet Rollershield. Smooth using trowel, brush or roller.
3. Apply jamb flashing in a similar manner.
4. Apply head flashing in a similar manner.
5. Apply wet Rollershield at all corners and embed diagonal reinforcement.

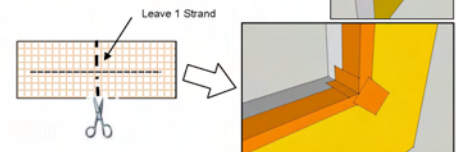

RSLAB-10 Basic Flashing – Method B

Information contained in this product data sheet conforms to the standard detail recommendations and specifications for the installation of Master Wall Inc.® products and is presented in good faith. Master Wall Inc.® assumes no liability, expressed or implied as to the architecture, engineering, or workmanship of any project. This information may be concurrent with, or superseded by other applicable documents, such as specifications and details. Contact Master Wall Inc.® for the most current product information. ©2017 Master Wall Inc.®

