



07 24 19

Rollershield Drainage

Drainage EIFS with a Liquid Applied Air & Water Barrier

Master Wall's Rollershield Drainage Class PB Exterior Insulation and Finish System is a high performance commercial wall cladding. It uses a roll-applied air and water barrier that can be used as a flashing-type material. Vertical adhesive channels drain away any incidental water entering the system. This highly adaptable cladding is suitable for both new and retrofit construction.

Features & Benefits

- 99% Drainage Efficiency
- High Insulating Value (R-4 per inch)
- CFC & HCFC Free Insulation Board, Recyclable
- Medium Impact Resistance is standard

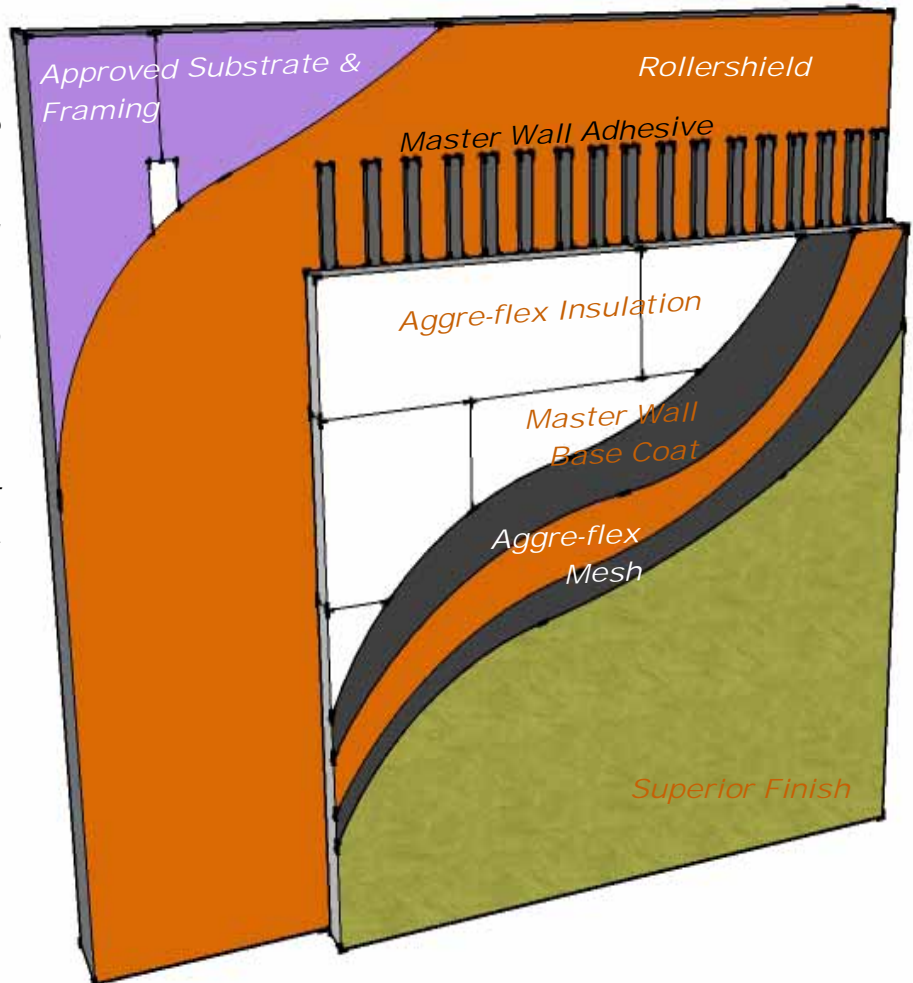

System Uses



©2011 Master Wall Inc.

P. O. Box 397
Fortson, GA 31808
800-755-0825
Technical 800-760-2861
masterwall.com

050111

Rollershield Drainage Short Form Specification

07 24 19



1.0 General

This is a short form specification. Refer to Aggre-flex Rollershield EIFS specifications and details for additional information.

1.1 System Description

The Master Wall Aggre-flex Rollershield Exterior Insulation and Finish System (EIFS) is a Class PB (Polymer Based) EIF System consisting of a roll-applied water barrier, adhesive attachment, insulation board, reinforcing mesh and a textured finish.

1.2 Design Requirements:

- A. Reference Master Wall suggested details and architectural drawings for specific detail requirements.
- B. Slope all surfaces a minimum of 1:2 (6" in 12") to shed water, maximum 12" (305mm) wide.
- C. Maximum deflection of substrates shall not exceed L/240.
- D. Typical acceptable substrates include unpainted brick, masonry, concrete or Dens Glass Gold® (ASTM C-1177). Contact Master Wall for other approved substrates.
- E. Expansion joints are required in the cladding at building expansion joints, panel joints, floor lines in wood framed construction, and other areas where significant movement occurs.

1.3 Quality Assurance

- A. The system shall be tested for: Accelerated weathering, mildew resistance, salt spray resistance and structural performance.
- B. The system shall have been tested for fire performance in accordance with ASTM E-108, ASTM E-84, UBC 26-9, and Radiant Heat.
- C. The system shall have been tested for water resistance in accordance with ASTM E-331.

1.4 Job Conditions

- A. Store all materials protected from weather and direct sunlight at temperatures above 40°F (5°C).
- B. The ambient and wall temperature shall be a minimum of 40°F (5°C) and shall remain so for at least 24 hours after installation.

2.0 Products

All components of the Rollershield System shall be manufactured by Master Wall and supplied by an authorized distributor.

- A. Water Barrier & Flashing Tapes:
 1. *Rollershield*: A 100% pure acrylic-based roll-applied weather-resistant barrier.
 2. *Trowelshield*: A 100% pure acrylic-based trowel grade water-resistant barrier.
 3. *Rollershield Mesh Tape*: A lightweight joint treatment material.
 4. *Rollershield Flashing Tape*: A lightweight non-woven joint treatment material.
- B. Master Wall Adhesives:
 1. *Foam & Mesh Adhesive (F&M)*: A 100% pure acrylic-based adhesive that is field mixed with Portland cement.
 2. *F&M Plus*: A high-build 100% pure acrylic-based fiber reinforced adhesive that is field mixed with Portland cement.
 3. *Master Wall Bagged Base (MBB)*: A ready to use dry base that is field mixed with water.
- C. *Master Wall Insulation Board*: Molded Expanded Polystyrene insulation board manufactured to Master Wall specifications.
- D. *Aggre-flex Mesh*: Available in Standard, Detail, Hi-Tech, Medium, Strong and Ultra.
- E. Master Wall Base Coats:
 1. *Foam & Mesh Adhesive (F&M)*
 2. *F&M Plus*
 3. *Master Wall Bagged Base (MBB)*
 4. *Guardian*: A waterproof 100% pure acrylic-based fiber reinforced adhesive that is field mixed with Portland cement.
- F. *Superior Finish*: 100% pure acrylic formulation with integral color and texture. Perfect, Spray, Desert Sand, R-Coarse and Refinish textures.
- G. Master Wall Coatings:
 1. *Primecoat & Sanded Primecoat*: A water-based primer.
 2. *Roller-flex*: A water-based architectural finish coating.

3.0 Installation

- A. Inspect the substrate to ensure that it is free of all foreign materials that would affect the adhesion of the Aggre-flex Rollershield EIFS System.
- B. Apply the system in strict accordance with Master Wall specifications, product data sheets, architectural drawings and architectural specifications.

More Information



See full specifications and details at masterwall.com

Rollershield Drainage EIFS