



# Master Wall Insulation Board

## Systems

Aggre-flex EIFS  
 Aggre-flex Drainage EIFS  
 Commercial Drainage EIFS  
 Cemplaster Stucco  
 OCS Fiberstucco  
 Rollershield Drainage EIFS  
 Stucco Cement Board Coatings  
 Trowelshield Drainage EIFS  
 Foam Trim

**VOC: 0.06-1.05% by Weight**  
**Manufacture Locations: varies**

**Packaging: 144 board foot bundles\***

### Coverage by Thickness:

3/4" (19.2 mm): 24 pcs,  
 192 sf (17.84 sm)

1" (25.2 mm): 18 pcs,  
 144 sf (13.38 sm)

1-1/2" (38.2 mm): 12 pcs,  
 96 sf (8.92 sm)

2" (50.8 mm): 9 pcs,  
 72 sf (6.69 sm)

3" (76.2 mm): 6 pcs, 4  
 8 sf (4.46 sm)

4" (101.6 mm): 5 pcs,  
 40 sf (3.72 sm)

\*Varies by manufacturer facility

### Board thickness:

Maximum 4" (102mm)

Minimum 3/4" (19.1mm)

Drainage Board 1.5" (38.2 mm)+

Board width, max.: 24"  
 (610mm)

Board length, max.: 48"  
 (1219mm)

Master Wall Insulation Board is a high performance insulation material that is used to wrap the entire building to keep interior temperatures more consistent. It helps to reduce thermal bridging at framing members and is easy to cut, rasp and place. It may be custom formed into various decorative shapes. Packaged in 144 board foot bundles, each bundle weights approximately 12 lbs (5.44 kg) and is available in flat or drainage configurations.



- Reduces air movement in wall
- Reduces life cycle CO<sub>2</sub> emissions
- Controls dew point / moisture condensation in wall
- Long lasting, strong stable
- Contains no CFC, HCFC, HFC or formaldehyde
- Recyclable
- Cost effective

Insulation Type	Density (pcf, minimum)	R-Value (U-Value) @75-F (9-C)	R-Value (U-Value) @40-F (4-C)
Standard Type I	0.90	3.6 (0.28)	4.0 (0.25)
Special Type II	1.35	4.0 (0.25)	4.6 (0.22)
Special Type VIII	1.15	3.8 (0.26)	4.2 (0.24)

### Product Test Standards

ASTM C578, ASTM 273, ASTM E2340, ASTM E2566





# Master Wall Insulation Board

## Application Procedure

**Job Conditions** - Follow directions on adhesive data sheets. Mechanical attachment of insulation boards may be performed at lower temperatures over a dry surface.

**Temporary Protection** – Provide temporary and permanent protection to prevent water entry behind the system.

**Substrate Preparation** – Applications must be to an approved substrate with a maximum variation tolerance of 1/4" in 10'-0" (6.4 mm in 3.05m). Contact Master Wall for approved substrates and recommended attachment methods.

## Application

The Insulation Board can be easily cut using handsaws, power saws, sharp knives, or thermal cutting tools. Rasping of the Insulation Board is completed with 12 grit sandpaper, manually or with air or electric rasping machines.

Follow data sheet recommendations for adhering insulation board to approved substrates. For mechanical attachment, fasten the Insulation Board to the approved substrate using Wind-Lock Wind-Devil 2 retainers. See Master Wall System Details for more information. Fastening patterns shall be determined by the requirements of the geographical conditions of the area, local code requirements, and the performance of the fasteners, retainers and their test results in conjunction with the specified substrate and the thickness of insulation board specified for use. Minimum 1" (25.2 mm) thickness for mechanically attached systems.

Classification: Type I

Density, lb/ft<sup>3</sup> (kg/m<sup>3</sup>):  
0.90 (14.4) min., 1.25 (20.0) max.

Thermal Resistance per inch (25.4mm) thickness, min. Fft<sup>2</sup>.h/Btu (K\*m<sup>2</sup>/W):

@75°F (23.9°C) 3.60 (0.63) U=.28

Compressive strength, min., PSI (kPa): 10.0 (69)

Flexural Strength, min., PSI (kPa): 25.0 (172)

Water Vapor Permeance of 1.00 in (25.2 mm) thickness, max., perm (ng/Pa.s.m<sup>2</sup>): 5.0 (2.87)

Water absorption by total immersion, max., volume, % : 4

Dimensional stability (change in dimensions), max., %: 2.0

Oxygen index, min., volume, %: 24.0

Flame spread, max.: 25.0

Smoke development, max. 450

Install insulation board on the wall according to specification requirements. For further information and details, see the Master Wall System Application Instructions.

## Limitations

The minimum required thickness for insulation board in the Master Wall Aggre-flex EIF System is 3/4" (19.2 mm) at any location on the wall.

MEPS shall not be used in interior applications.

Residential applications require a secondary water barrier with the option of flat insulation board with profiled water barriers or drainage insulation board. See Aggre-flex Drainage Details for insulation board construction.

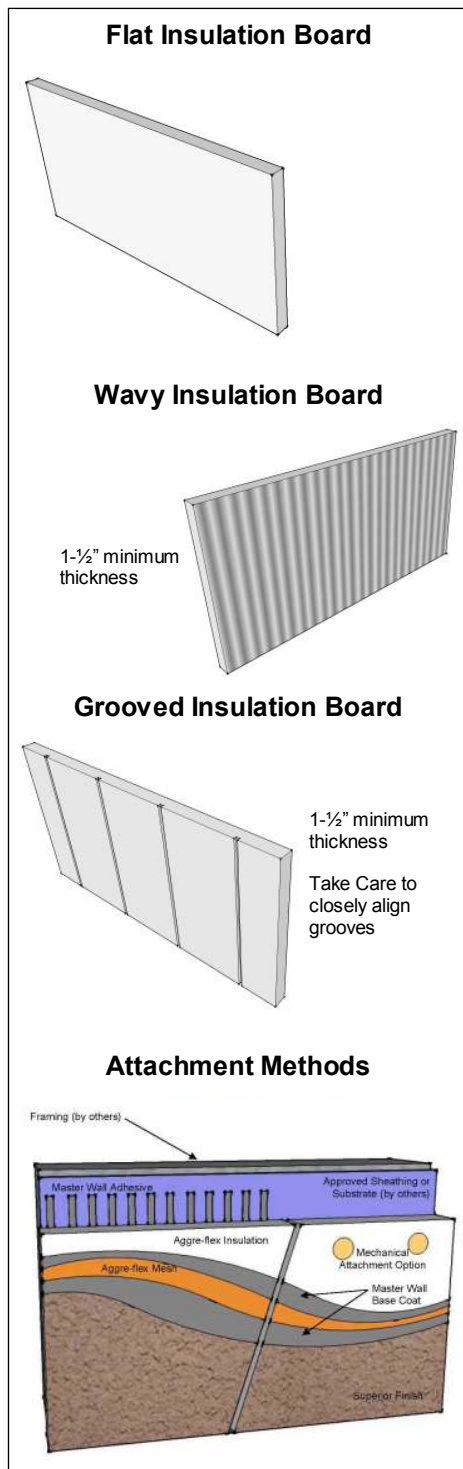

Information contained in this product data sheet conforms to the standard detail recommendations and specifications for the installation of Master Wall Inc.® products and is presented in good faith. Master Wall Inc.® assumes no liability, expressed or implied as to the architecture, engineering, or workmanship of any project. This information may be concurrent with, or superseded by other applicable documents, such as specifications and details. Contact Master Wall Inc.® for the most current product information. ©2016 Master Wall Inc.®



PO Box 397 • Fortson • GA • 31808 • 800-755-0825 • Tech: 800-760-2861