



07 24 13

Aggre-flex System

Barrier Wall Exterior Insulation and Finish System

Master Wall's Aggre-flex System is a polymer-based (Class PB) Exterior Insulation and Finish System (EIFS). The Aggre-flex System blankets commercial projects in a layer of protective insulation reducing thermal losses at framing members and better insulating the entire building.

The Aggre-flex System offers many options from its weather-resistant monolithic exterior to design flexibility and ease of design. It has the visual appeal that architects and owners look for without the weight or expense of traditional materials.

Features & Benefits

- High Insulating Value (R-4 per inch)
- Design Flexibility
- Medium Impact Resistance is standard

System Uses

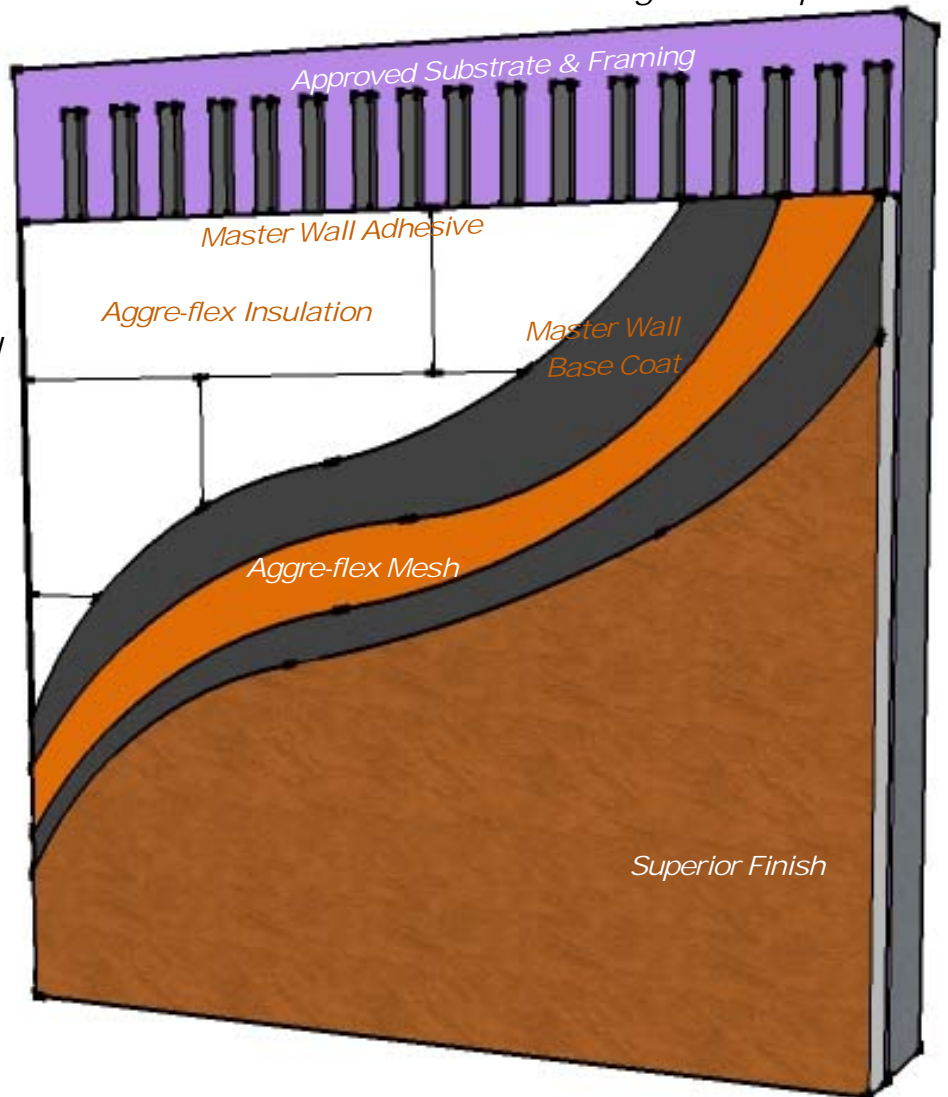

P. O. Box 397
 Fortson, GA 31808
 800-755-0825
 Technical 800-760-2861
masterwall.com

Aggre-flex Short Form Specification

07 24 13



1.0 General

This is a short form specification. Refer to Aggre-flex specifications and details for additional information.

1.1 System Description

The Master Wall Aggre-flex Exterior Insulation and Finish System (EIFS) is a Class PB (Polymer Based) EIF System consisting of mechanical or adhesive attachment, insulation board, reinforcing mesh and a textured finish.

1.2 Design Requirements:

- A. Reference Master Wall suggested details and architectural drawings for specific detail requirements.
- B. Slope all surfaces a minimum of 1:2 (6" in 12") to shed water, maximum 12" (305 mm) wide.
- C. Maximum deflection of substrates shall not exceed L/240.
- D. Typical acceptable substrates include unpainted brick, masonry, concrete, Portland cement plaster (stucco), exterior grade gypsum sheathing (ASTM C-79), Dens Glass Gold® (ASTM C-1177), CDX exterior grade plywood, Exposure 1 Oriented Strand Board (OSB). Contact Master Wall for other approved substrates.
- E. Expansion joints are required at building expansion joints, panel joints, floor lines in wood framed construction, and other areas where significant movement occurs.

1.3 Quality Assurance

- A. The Aggre-flex System shall be recognized by local building codes.
- B. The system shall be tested for: Accelerated weathering, mildew resistance, salt spray resistance and structural performance.
- C. The system shall have been tested for fire performance in accordance with ASTM E-108, ASTM E-84, UBC 26-9, and Radiant Heat.
- D. The system shall have been tested for water resistance in accordance with ASTM E-331, IBC 00 (Section 1403.2).

1.4 Job Conditions

- A. Store all materials protected from weather and direct sunlight at temperatures above 40°F (5°C).
- B. The ambient and wall temperature shall be a minimum of 40°F (5°C) and shall remain so for at least 24 hours after installation.

2.0 Products

All components of the Aggre-flex System shall be manufactured by Master Wall and supplied by an authorized distributor.

A. Master Wall Adhesives & Fasteners:

1. Foam & Mesh Adhesive (F&M): A 100% pure acrylic-based adhesive that is field mixed with Portland cement.
2. F&M Plus: A high-build 100% pure acrylic-based fiber reinforced adhesive that is field mixed with Portland cement.
3. Master Wall Bagged Base (MBB): A ready to use dry base that is field mixed with water.
4. Guardian: A waterproof 100% pure acrylic-based fiber reinforced adhesive that is field mixed with Portland cement.
5. EPSA: A ready to use non-cement acrylic copolymer adhesive.
6. Fastener: Wind-Lock Wind Devil 2 washer and appropriate fastener or approved equal.

B. Master Wall Insulation Board: Molded Expanded Polystyrene insulation board manufactured to Master Wall specifications.

C. Aggre-flex Mesh: Available in Standard, Detail, Hi-Tech, Medium, Strong and Ultra.

D. Master Wall Base Coats:

1. Foam & Mesh Adhesive (F&M).
2. F&M Plus.
3. Master Wall Bagged Base (MBB).
4. Guardian.
5. EPSB: A ready to use non-cement acrylic copolymer base coat.

E. Superior Finish: 100% pure acrylic formulation with integral color and texture. Perfect, Spray, Desert Sand, R-Coarse and Refinish textures.

F. Master Wall Coatings:

1. Primecoat: A water-based primer.
2. Sanded Primecoat: Sanded water-based primer.
3. Roller-flex: A water-based architectural finish coating.

3.0 Installation

A. Inspect the substrate to ensure that it is free of all foreign materials that would affect the adhesion or attachment of the Aggre-flex System.

B. Apply the system in strict accordance with Master Wall specifications, product data sheets, architectural drawings and architectural specifications.

More Information



Aggre-flex EIFS

See full specifications
and
details at masterwall.com

Information contained in this product data sheet conforms to the standard detail recommendations and specifications for the installation of Master Wall Inc. products and is presented in good faith. Master Wall Inc. assumes no liability, expressed or implied as to the architecture, engineering, or workmanship of any project. This information may be concurrent with, or superseded by other applicable documents, such as specifications and details. Contact Master Wall Inc. for the most current product information.