



07 24 19

Aggre-flex Drainage System

Drainage Type Wall Exterior Insulation and Finish System

Master Wall's Aggre-flex Drainage System is a mechanically attached polymer based (Class PB Drainage) Exterior Insulation and Finish System (EIFS). The system is applied over an approved secondary water barrier that helps protect the building from incidental water intrusion while insulating the entire building in a blanket of protective insulation.

Aggre-flex Drainage may be installed with flat insulation board, Master Wall wavy insulation board or a drainage spacer.

Features & Benefits

- 97% Drainage Efficiency
- High Insulating Value (R-4 per inch)
- Medium Impact Resistance is standard

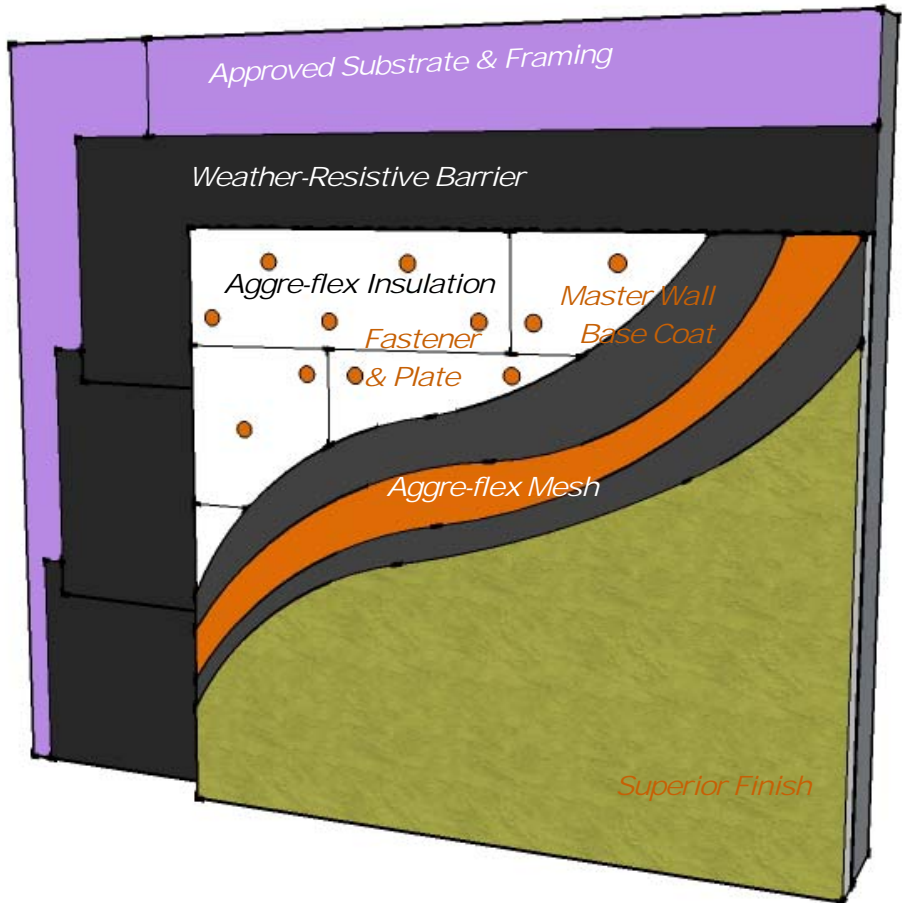

©2011 Master Wall Inc.

P. O. Box 397
 Fortson, GA 31808
 800-755-0825
 Technical 800-760-2861
 masterwall.com

050111

1.0 General

This is a short form specification. Refer to Aggre-flex Drainage specifications and details for additional information.

1.1 System Description

The Master Wall Aggre-flex Drainage Exterior Insulation and Finish System (EIFS) is a Class PB (Polymer Based) EIF System consisting of mechanical attachment, insulation board, reinforcing mesh and a textured finish applied over a secondary weather-resistive barrier.

1.2 Design Requirements:

- A. Reference Master Wall suggested details and architectural drawings for specific detail requirements.
- B. Slope all surfaces a minimum of 1:2 (6" in 12") to shed water, maximum 12" (305 mm) wide.
- C. Maximum deflection of substrates shall not exceed L/240.
- D. Typical acceptable substrates include exterior grade gypsum sheathing (ASTM C-79), Dens Glass Gold® (ASTM C-1177), CDX exterior grade plywood, Exposure 1 Oriented Strand Board (OSB). Contact Master Wall for other approved substrates.
- E. A code-approved weather-resistive barrier is required over the substrate.
- F. Expansion joints are required at building expansion joints, panel joints, floor lines in wood framed construction, and other areas where significant movement occurs.
- G. Detail and install drainage trim accessories according to the approved trim manufacturer's requirements (Plastic Components, Vinyl Corp. or approved equal).

1.3 Quality Assurance

- A. The Aggre-flex Drainage System shall be recognized by current applicable building codes.
- B. The system shall be tested for: Accelerated weathering, mildew resistance, salt spray resistance and structural performance.
- C. The system shall have been tested for fire performance in accordance with ASTM E-108, ASTM E-84, UBC 26-9, and Radiant Heat.

More Information



See full specifications and details at masterwall.com

Aggre-flex Drainage EIFS

1.4 Job Conditions

- A. Store all materials protected from weather and direct sunlight at temperatures above 40°F (5°C).
- B. The ambient and wall temperature shall be a minimum of 40°F (5°C) and shall remain so for at least 24 hours after installation.

B. 2.0 Products

All components of the Aggre-flex Drainage System shall be manufactured by Master Wall and supplied by an authorized distributor.

- A. Master Wall Approved Fasteners: Wind-Lock Wind Devil 2 washer and appropriate fastener or approved equal.
- B. Master Wall Insulation Board: Molded Expanded Polystyrene insulation board manufactured to Master Wall specifications. Flat or wavy (grooved) insulation as required by the project specifications.
- C. Aggre-flex Mesh: Available in Standard, Detail, Hi-Tech, Medium, Strong and Ultra.
- D. Master Wall Base Coats:
 1. Foam & Mesh Adhesive (F&M): A 100% pure acrylic-based adhesive that is field mixed with Portland cement.
 2. F&M Plus: A high-build 100% pure acrylic-based fiber reinforced adhesive that is field mixed with Portland cement.
 3. Master Wall Bagged Base (MBB): A ready to use dry base that is field mixed with water.
 4. Guardian: A waterproof 100% pure acrylic-based fiber reinforced adhesive that is field mixed with Portland cement.
 5. EPSB: A ready to use non-cement acrylic copolymer base coat.
- E. Superior Finish: 100% pure acrylic formulation with integral color and texture. Perfect, Spray, Desert Sand, R-Coarse and Refinish textures.
- F. Master Wall Coatings:
 1. Primecoat: A water-based primer.
 2. Sanded Primecoat: Sanded water-based primer.
 3. Roller-flex: A water-based architectural finish coating.

3.0 Installation

- A. Inspect the substrate to ensure that it is free of all foreign materials that would affect the application of the Aggre-flex Drainage System.
- B. Apply the system in strict accordance with Master Wall specifications, product data sheets, architectural drawings and architectural specifications.